

REQUEST FOR PROPOSALS  
FOR  
OPERATION AND MAINTENANCE  
OF  
SANITARY SEWER AND TREATMENT FACILITIES  
FOR  
COUNTY SERVICE AREA NO. 7 BOULDER CREEK

I. INTRODUCTION

This request is a solicitation of proposals from qualified operators for the contract operation and maintenance of County Service Area (CSA) No. 7, Boulder Creek, sanitation facilities. These facilities include all sewage collection system components, one tertiary sewage treatment facility, reclaimed water pumps and transmission lines, a treated effluent force main, leach field at the end of Fern Rock Way, and miscellaneous appurtenances. These facilities are more specifically described in Exhibit A and are delineated in the Subdivision Improvement Plans for the Boulder Creek Country Club Estates and Culligans Country Club Villas Subdivisions, and are available for review at the Santa Cruz County Public Works Department, 701 Ocean Street, Room 410, Santa Cruz, California 95060. The CSA No. 7 service area is shown on Exhibit B.

II. FACILITY DESCRIPTION AND OPERATION

CSA No. 7 facilities serve residential housing and one commercial business within the Boulder Creek Country Club subdivision. The facilities were constructed by the developer of the subdivision and later dedicated to CSA No. 7 for ownership and operation. Lift stations pump the wastewater to the treatment plant, which is located adjacent to the 17th green of the golf course along an easement road that is an extension of Lake Avenue. The wastewater treatment plant was constructed in the 1970s and upgraded to tertiary treatment in the 1990s.

The original treatment plant was constructed in 1978 and has a design capacity of 104,000 gallons per day (gpd). The plant was constructed to accommodate flows from the Boulder Creek Country Club development totaling 260 residences and a commercial establishment. This plant was upgraded to tertiary treatment in 1996 in order to reduce nitrate levels in the effluent that is pumped via force main to the leach field at Fern Rock Way. This is an activated sludge nitrification/denitrification process. The processes include one primary clarifier, one sand filter (multi media sand), a sludge holding tank, effluent discharge line, emergency generator, and one grinder. The facility also contains a small laboratory for performing basic analyses, such as pH and temperatures.

The facilities are designed to provide an effluent that meets the most stringent requirements of Title 22 of the California Administrative Code (Wastewater Reclamation Criteria) for irrigation of public accessible land. Current flow for the facility is about 40,000 gpd and the facility is presently operating within discharge requirements.

The collection system consists of 24 miles of 6 and 8-inch gravity mains and a 4-inch PVC force main, approximately 60 manholes, and five lift stations. The irrigation transmission lines consist of 2.5 miles of 4 and 2-inch diameter pressure main and pumps, which deliver the water to the irrigation system at Boulder Creek Country Club. The irrigation system is owned and operated by the Boulder Creek Country Club and is not included as services requested in this Request for Proposals (RFP).

The billing is provided by the County and is not included as services requested in this RFP.

### III. PERMITS

The selected operator will be required to operate and maintain all facilities in conformance with the requirements of all permits. Copies of the permits from the Monterey Bay Unified Air Pollution Control District, the County of Santa Cruz Health Department, and the California Regional Water Quality Control Board are attached for reference as Exhibit C.

### IV. SCOPE OF WORK

This RFP solicits qualified wastewater operations firms to provide all services required to manage, coordinate, operate, and maintain the collection and treatment facilities. Submitted proposals shall contain a proposed Scope of Work detailing the services to be provided, the cost to provide that service, and the method of payment. The Scope of Work for services shall include, but not be limited to, how the firm intends to meet the following:

1. Appropriate qualified staffing to provide for sampling, testing, sludge handling, monitoring, operating, and maintaining the treatment facilities seven days per week throughout the year.
2. Ability to provide additional qualified staffing when required by the operation.
3. Appropriate staffing and equipment to provide cleaning, repair, maintenance, and inspection of the sewage collection system to include manholes, cleanouts, and lines at least twice per year, and more often if needed. Lift stations shall be inspected and cleaned thoroughly once per week to include exercising operation of emergency power equipment and addition of chemicals, as applicable.
4. Staffing to complete daily inspection of the treated effluent at the tank and at Pump Station No. 2, and implement source control within the subdivision.
5. Inspection and repair of all security and safety devices to include fencing, gates, etc., shall be completed a minimum of twice per month and more often if needed.
6. 24-hour/day emergency response capability. Submitted proposals shall demonstrate firm's ability to respond to all facilities within 30 minutes of alarm.
7. Provide appropriate hand tools and associated equipment as well as transportation to complete the task required by the Scope of Work.
8. Describe how miscellaneous maintenance of equipment is to be scheduled and performed such as pumps, generators, electrical controls, etc.
9. Describe how the operator proposes to handle confined-space entries.
10. Describe how long it will take to transition from County staffing to operator staffing.
11. Complete and submit all required reports for the facilities under the attached permits
12. Laboratory services; necessary to operate treatment plant and fulfill the State's reporting requirements.
13. Minimum monthly inspection of leach fields, as required by the State.

### V. FORM OF CONTRACT

The selected operator shall execute a standard form of Independent Contractor Agreement.

## VI. TERM OF CONTRACT

The term of the Operating Agreement shall be for two years, beginning on the date of execution. The Agreement shall provide for two, two-year extensions at the mutual agreement of the parties.

## VII. TOUR

A tour of the CSA No. 7 facilities will be conducted for all interested firms on December 17, 2003, at 8:00 a.m.

## VIII. SELECTION CRITERIA

The County shall evaluate proposals based on information submitted in the proposal with emphasis on the following elements:

1. Annual not-to-exceed cost to provide the services described in the Scope of Work.
2. Demonstrated understanding of the services and products required, and quality and thoroughness of the proposal, to include the Scope of Work.
3. Professional qualifications of the firm and firm's personnel proposed for this project with special focus on the background and ability of people proposed for the job.
4. Demonstrated experience and success of personnel working on projects of similar scope and circumstances.
5. References from clients who have retained the operator for projects of similar scope and circumstances.
6. Demonstrated ability to achieve the Scope of Work in the required time frame.

Each proposal will be evaluated by a County review panel and submitting firms may be requested to give a presentation of the proposal. The successful firm will be notified of selection and will be invited to execute a contract based on the provided form. The selected operator will be required to submit a performance bond in the amount of 100 percent of the contract value. Upon execution of the agreement, a Notice to Proceed will be issued and a project kick-off meeting will be scheduled.

## IX. NOTICE TO ALL INTERESTED PARTIES (DISCLAIMER)

The County of Santa Cruz reserves complete discretion to select the entity or entities it believes is best qualified to perform the required level of utility services in light of a number of factors to be considered as part of the Request for Proposals. The County is not obligated or bound by this Request for Proposals to select any firm or enter into a contract to operate. County staff has 120 days to review the submitted statements, develop the required agreement, and implement a contract. All parties responding to this request acknowledge this Disclaimer and agree that they are solely responsible for all costs associated with preparation and submittal of the proposal and negotiation of an agreement to operate.

**X. TIME FRAME FOR SUBMITTALS**

Submissions in response to this request by potential operators shall be presented to the County of Santa Cruz Department of Public Works, 701 Ocean Street, Room 410, Santa Cruz, CA 95060, no later than 5:00 p.m., January 14, 2004. The proposal shall be returned with a corporate or municipal letterhead signed by a representative authorized to enter into contracts on behalf of the corporation or by a duly authorized representative of an agency presenting a proposal, to be considered as a potential operator of the system.

Additional information on the RFP can be obtained from:

Mr. Russ Bateson  
Manager of Sanitation Operations  
701 Ocean Street, Room 410  
Santa Cruz, CA 95060  
(831) 464-5462

CSA No. 7 BOULDER CREEK, SANITATION FACILITIES

The original treatment plant was constructed in 1978 and has a design capacity of 104,000 gallons per day (gpd). The plant was constructed to accommodate flows from the Boulder Creek Country Club development totaling 261 residences and a commercial establishment. The process includes one primary clarifier, one sand filter by gravity filtration, a sludge holding tank, effluent discharge line, and an emergency generator. The treatment plant contains a laboratory used for process control. A contract laboratory performs all other testing and analyses. The blower room contains two blowers used for supplying air treatment for plant processes.

The facilities are designed to provide an effluent that meets the most stringent requirements of Title 22 of the California Administrative Code (Wastewater Reclamation Criteria) for irrigation of public accessible land. Current flow for the facility is about 40,000 gpd and the facility is presently operating within discharge requirements.

The collection system consists of 24 miles of 6 and 8-inch gravity mains and a 4-inch PVC force main, approximately 60 manholes, and five lift stations. The irrigation transmission lines consist of 2.5 miles of 2-inch diameter pressure main and pumps, which deliver the water to the irrigation system at Boulder Creek Country Club golf course. The irrigation system to the golf course is owned and operated by Boulder Creek Country Club and is not included as services requested in this RFP. When the irrigation system is not delivering water to the Country Club, it is pumped uphill to the leach fields for percolation near Fern Rock Way.

Lift Station No. 1 is located on Hilton Drive. The station contains two, 3-phase 230 volt 2HP Hydromatic pumps and has a 15kW emergency generator. A designated telephone line delivers alarms to the dispatch office indicating level and equipment alarms.

Lift Station No. 2 is located at the treatment plant site off Hare Way. The station contains two, 3-phase 230 volt 3HP Hydromatic pumps and has a 160kW emergency generator. A designated telephone line delivers alarms to the dispatch office indicating level and equipment alarms.

Lift Station No. 3 is located at State Highway 236 and Fallen Leaf Drive. The station contains two, 3-phase 460 volt 25HP Cornell pumps and has a 200kW emergency generator. A designated telephone line delivers alarms to the dispatch office indicating level and equipment alarms.

Lift Station No. 4 is located at the top of Hilton Drive. The station contains two, 3-phase 230 volt 5HP Paco pumps and has a 25kW emergency generator. A designated telephone line delivers alarms to the dispatch office indicating level and equipment alarms.

Lift Station No. 5 is located on State Highway 236 halfway between Hilton Drive and Lucille Court. The station contains two, 3-phase 230 volt 5HP Wemco pumps and has a 25kW emergency generator. A designated telephone line delivers alarms to the dispatch office indicating level and equipment alarms.

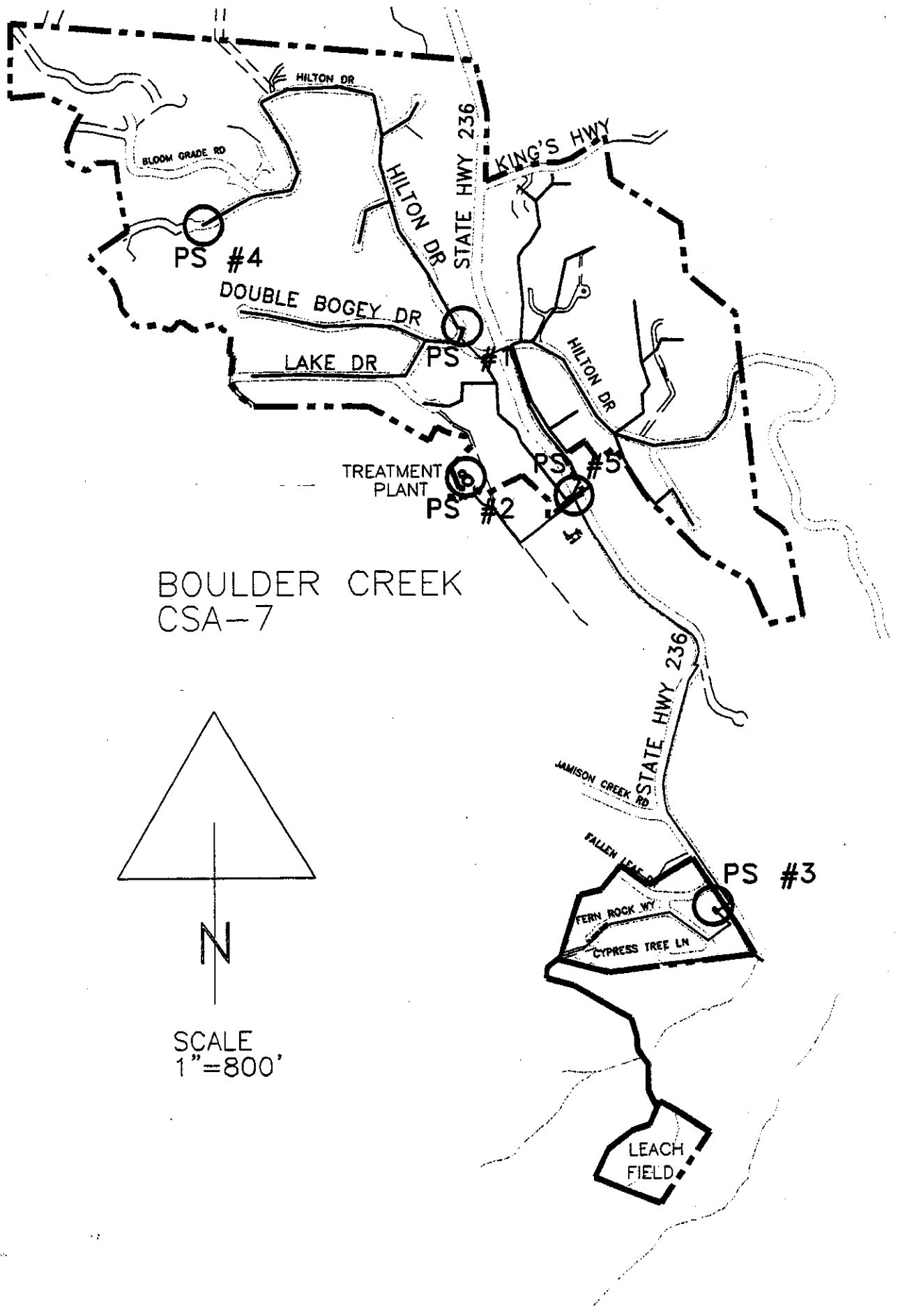

BOULDER CREEK  
CSA-7

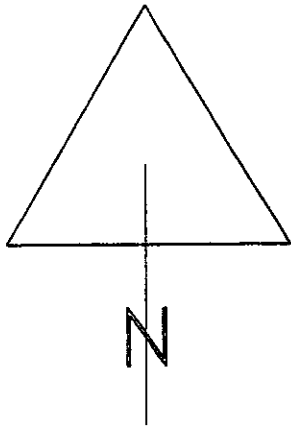

SCALE  
1"=800'



# California Regional Water Quality Control Board

## Central Coast Region



Winston H. Hickox  
Secretary for  
Environmental  
Protection

Internet Address: <http://www.swrcb.ca.gov/rwqcb3>  
81 Higuera Street, Suite 200, San Luis Obispo, California 93401-5427  
Phone (805) 549-3147 • FAX (805) 543-0397

Gray Davis  
Governor

May 23, 2001

A 383

John Fantham, District Engineer  
Department of Public Works  
701 Ocean Street, Room 410  
Santa Cruz, CA 95060-4070



Dear Mr. Fantham:

**ADOPTION OF WASTE DISCHARGE REQUIREMENTS ORDER NO. 01-034 FOR SANTA CRUZ COUNTY SERVICE AREA (CSA) #7, BOULDER CREEK GOLF AND COUNTRY CLUB, SANTA CRUZ COUNTY**

Please find attached Order No. 01-034 as adopted by the Regional Board at the May 18, 2001 Regional Board meeting in San Luis Obispo, California.

The adopted Order renews Waste Discharge Requirements (WDR) for Boulder Creek Golf and Country Club, and will supersede Order No. 96-03, which has been rescinded.

The adopted Order includes the *Standard Provisions and Reporting Requirements for Waste Discharge Requirements*, which were previously mailed to you with the draft of the proposed Order on January 23, 2001.

If you have any questions, please call Todd Stanley at (805) 542-4769 or Chris Adair at (805) 549-3761.

Sincerely,

Roger W. Briggs  
Executive Officer

Enclosures:

1. Waste Discharge Requirements Order No. 01-034
2. Monitoring and Reporting Program No. 01-034

cc:

Jim Kassel  
Division of Water Quality  
P.O. Box 944144-2130  
Sacramento, CA 94144-2130

S:\WB\Northern Watershed\TLS\Finalized\WDR\Santa Cruz CSA #7 - Boulder Cree  
Task: 121-01

File: Discharger file; Brookdale Lodge/ Brookdale Lodge

*California Environmental Pro*

NO.	ROUTE DATA	COPY	ATT.
1	DIRECTOR	✓	
	ASST. DIR. SPEC. SVCS.		
	SOLID WASTE ENG.		
	LANDFILL OPERATIONS		
	PAJARO COORD.		
	DRAINAGE ENG.		
	DRAINAGE OPERATIONS		
	CONSTRUCT. ENG.		
2	ASST. DIR. DEV. SVCS.	✓	
3	SANITATION ENG.	✓	✓
	WATER & WASTEWATER		
	SURVEY / DEVELOPMT.		
	RDA ENG.		
	ASST. DIR. TRANSPORT.		
	ROAD OPS. ENG.		
	PERMITS / ENCROACH.		
	RD. MAINT/LIVE OAK P.		
	ROAD DESIGN ENG.		
	TRANSP / RD. PLANNING		
	DIR. OF ADMIN. SERVICES		
	REAL PROPERTY		
	CSA / PRGM ADMIN.		
	SAFETY OFFICER / FLEET		

STATE OF CALIFORNIA  
CALIFORNIA REGIONAL WATER QUALITY CONTROL BOARD  
CENTRAL COAST REGION  
81 Higuera Street, Suite 200  
San Luis Obispo, California 93401-5427

WASTE DISCHARGE REQUIREMENTS ORDER NO. 01-034  
WDID No. 3 440801001

FOR

SANTA CRUZ COUNTY SERVICE AREA (CSA) #7  
BOULDER CREEK GOLF AND COUNTRY CLUB  
SANTA CRUZ COUNTY

The California Regional Water Quality Control Board, Central Coast Region, (Hereinafter called the Regional Board) finds that:

**SITE OWNER AND LOCATION**

1. On July 3, 2000, John A. Fantham, California County of Santa Cruz, District Engineer, filed a Report of Waste Discharge. The report was filed on behalf of Santa Cruz CSA #7, Boulder Creek Golf and Country Club Wastewater Treatment Facility for authorization to continue discharging treated domestic wastewater within the San Lorenzo River sub-basin.
2. County of Santa Cruz (hereafter Discharger), Department of Public Works, 701 Ocean Street, Room 410, Santa Cruz, owns and operates a an extended aeration wastewater treatment package plant. The facility either discharges effluent to a four-trench leachfield disposal system, or effluent is reused for golf course irrigation. The facility is located in Santa Cruz County at 16901 Big Basin Highway, Boulder Creek, as shown on Attachment A of this Order.

**PURPOSE OF ORDER**

3. The purpose of this order is to regulate the discharge of treated domestic wastewater.

**SITE/FACILITY DESCRIPTION**

**Discharge Type**

4. The facility is designed to treat and dispose domestic wastewater from residential dwellings.
5. The facility also receives wastewater from one restaurant.

**Design and Current Capacity**

6. The facility is an extended aeration wastewater treatment package plant with discharge to a four-trench leachfield disposal system and/or for reuse as golf course irrigation. (See Attachments A & B).
7. When the wastewater is to be used for irrigation, additional treatment is required (chemical coagulation, sand filtration, and disinfection).
8. The estimated treatment plant capacity is 104,000 gallons per day (gpd). The facility treats an average dry weather flow of 40,000 gpd and an average wet weather flow of 55,000 gpd.



**Geology**

9. The disposal area is located on sloping topography (approximately 15% slope) consisting of coarse, sandy soils with some intermixed cobbles.
10. The general soil profile of the golf course is 2 to 5 feet of silty sand and clay overlying sandstone bedrock. The golf course reclamation area and a reclaimed water reservoir are located on fairly level topography. The reclamation area is approximately 50 acres.

**Surface and Groundwater**

11. The facility is located in the middle portion of the San Lorenzo River watershed. An unnamed drainageway lies approximately 400 feet from the leachfield and flows in a northeasterly direction for 1600 feet before entering Boulder Creek. The reclamation area lies about 200 feet northeast of Boulder Creek. Boulder Creek flows for approximately 2 1/2 miles downstream of the site until it empties into the San Lorenzo River.
12. Depth to ground water is estimated to be 25 feet and generally migrates in an easterly direction. No ground water data has been collected by the Discharger near this facility.
13. The nearest ground water well is approximately 1000 feet up gradient from the leachfield disposal area.
14. Storm water flows from the vicinity of the leachfield area and into the Boulder Creek. Because the flow is less than 1 million gpd, the facility is not required to have a storm water pollution prevention plan (see storm water control requirements in Specification No. 10 of this Order).

**MONITORING AND REPORTING PROGRAM (MRP)**

15. The MRP requires influent monitoring, effluent monitoring, and system performance

monitoring. No ground or surface water monitoring is proposed at this time.

16. Sampling and inspection results shall be reported quarterly by the 1<sup>st</sup> day of February, May, August, and November.

**BASIN PLAN**

[Note: Superscripts are provided throughout the Order to indicate the source of the requirements specified.]

- BP = Basin Plan  
 B = California Code of Regulations, Title 22, Division 4, Chapter 3  
 C = Draft Guidelines for the Use of Reclaimed Water (California Department of Health Services)

Requirements not referenced are based on Regional Board staff's best professional judgment for the sufficient protection of beneficial uses.]

17. The Water Quality Control Plan, Central Coastal Basin (Basin Plan), was adopted by the Regional Board on November 17, 1989, and approved by the State Water Resources Control Board on August 16, 1990. The Regional Board approved amendments of the Plan on February 11, 1994 and September 8, 1994. The Basin Plan incorporates statewide plans and policies by reference and contains a strategy for protecting beneficial uses of State waters.<sup>BP</sup>
18. Present and anticipated beneficial uses of San Lorenzo River that could be affected by the discharge include:<sup>BP</sup>
  - a. Domestic and municipal supply;
  - b. Agricultural supply;
  - c. Industrial service supply;
  - d. Ground water recharge;
  - e. Water contact recreation;
  - f. Non-contact water recreation;
  - g. Wildlife habitat;
  - h. Cold fresh-water habitat;
  - i. Fish migration;
  - j. Fish spawning;

- k. Preservation of Biological Habitats of Special Significance;
- l. Rare, Threatened, or Endangered Species;
- m. Fresh Water Replenishment; and
- n. Commercial and Sport Fishing.

19. Present and anticipated uses of groundwater in the vicinity of the discharge include: <sup>BP</sup>

- a. Domestic supply;
- b. Agricultural supply;
- c. Industrial process supply; and
- d. Industrial service supply.

20. The San Lorenzo Wastewater Management Plan (WWMP), adopted by the Santa Cruz County Board of Supervisors, was approved by the Regional Board on April 5, 1995 as Resolution No. 95-04. The WWMP includes findings and recommendations resulting from the investigation of elevated nitrate levels in surface water and groundwater in the San Lorenzo River watershed. The WWMP recommends the Regional Board require nitrogen control measures in the issuance of new or revised waste discharge requirements. The WWMP's goal is for at least 50 % reduction in nitrogen from onsite disposal systems. <sup>BP</sup>

21. This order requires 50 % reduction of nitrogen in effluent, consistent with Resolution No. 95-04. <sup>BP</sup>

22. The Basin Plan surface water quality objectives specified for Boulder Creek are: <sup>BP</sup>

Analyte	Value	Units
Total Dissolved Solids	150	mg/l
Sodium	20	mg/l
Chloride	10	mg/l
Boron	0.2	mg/l
Sulfate	10	mg/l

23. The range of median ground water quality objectives in the San Lorenzo Sub-Basin, as specified in the Basin Plan, are: <sup>BP</sup>

Analyte	Range	Units
Total Dissolved Solids	100-250	mg/l
Sodium	10-20	mg/l
Chloride	20-30	mg/l
Boron	0.2	mg/l
Nitrate (as N)	1-5	mg/l
Sulfate	10-50	mg/l

#### CEQA

24. These waste discharge requirements are for an existing facility and are exempt from provisions of the California Environmental Quality Act (Public Resources Code, Section 21000, et seq.) in accordance with Section 15301, Chapter 3, Title 14, of the California Code of Regulations.

#### EXISTING ORDERS AND GENERAL FINDINGS

25. The discharge has been regulated by Waste Discharge Requirements Order No. 96-03, adopted by the Regional Board on May 31, 1996. The Regional Board has regulated the discharge from Santa Cruz CSA #7, Boulder Creek Golf and Country Club Wastewater Treatment Facility since 1970.

26. Discharge of waste is a privilege, not a right, and authorization to discharge is conditional upon the discharge complying with provisions of Division 7 of the California Water Code and any more stringent effluent limitations necessary to implement water quality control plans, to protect beneficial uses, and to prevent nuisance. Compliance with this Order should assure this and mitigate any potential adverse changes in water quality due to the discharge.

27. On January 23, 2001, the Regional Board notified the Discharger and interested agencies and persons of its intent to adopt waste discharge requirements for the discharge and has provided them with a copy of the proposed Order and an opportunity to submit written views and comments.

28. In a public hearing on May 18, 2001, the Regional Board heard and considered all comments pertaining to the discharge and found this Order consistent with the above findings.

IT IS HEREBY ORDERED, pursuant to authority in Section 13263 of the California Water Code, that the County of Santa Cruz, its agents, successors, and assigns, may discharge wastewater at Santa Cruz CSA #7, Boulder Creek Golf and Country Club Wastewater Treatment Facility, providing compliance is maintained with the following:

[Note: Other prohibitions and conditions, definitions, and the method of determining compliance are contained in the attached "Standard Provisions and Reporting Requirements for Waste Discharge Requirements" dated January 1984. Applicable paragraphs are referenced in Provision No. 3 of this Order.]

#### PROHIBITIONS

1. Discharge of wastewater to the treatment system from other than Santa Cruz CSA #7, Boulder Creek Golf and Country Club Wastewater Treatment Facility, is prohibited.
2. Discharge to areas other than designated reclamation areas and leachfield disposal areas shown in Attachment A is prohibited.
3. Wastewater on the soil surface of the leachfield disposal area is prohibited.
4. Bypass of the collection and treatment systems is prohibited.
5. Discharge of untreated or partially treated wastes directly to the leachfield disposal area is prohibited.
6. Bypass of the treatment facility, and discharge of untreated or partially treated

wastes directly to the reclamation area is prohibited.

7. Wastewater shall not be reclaimed or discharged within 150 feet of any well used for domestic purposes, or within 100 feet of any surface stream or drainage way.
8. Use of reclaimed water not in compliance with Title 22, Division 4, Chapter 3, Article 4, Section 60313 (b) of the California Code of Regulations (adequately oxidized, coagulated, clarified, filtered, disinfected wastewater, or a wastewater treated by a sequence of unit processes that will assure an equivalent degree of treatment and reliability), is prohibited.<sup>B</sup>

#### RECLAMATION SPECIFICATIONS

1. Daily flow averaged over each month shall not exceed 104,000 gallons per day.
2. Reclaimed water discharge shall not exceed the following limits:

Parameter	Units	Monthly Mean	Maximum
Turbidity	NTU	2	5
BOD-5	mg/l	20	25
Suspended Solids	mg/l	20	25

3. The median number of total coliform organisms in reclaimed water shall not exceed 2.2 per 100 milliliters, as determined from the bacteriological results of the last 7 days for which analyses have been completed, and the number of coliform organisms shall not exceed 23 per 100 milliliters in any sample.<sup>B</sup>
4. Reclaimed water shall not have a pH less than 6.5 or greater than 8.3.<sup>BP</sup>
5. If reclamation specifications are violated, the discharger shall:
  - a. Divert wastewater to the existing leachfield disposal area; and

- b. Immediately notify all affected reclaimed water users, the County Environmental Health Service, and this Regional Board's Executive Officer (also see General Reporting Requirement No. C.4 of the attached *Standard Provisions and Reporting Requirements for Waste Discharge Requirements*).
- 6. Irrigation of reclaimed water shall occur at a time and in a manner that minimizes the possibility of public contact with reclaimed water, ponding, and runoff, and that allows irrigated areas maximum opportunity to dry before use. Drinking fountains shall be protected from direct or windblown spray of reclaimed water. No spray irrigation is allowed during strong winds when over spray may reach dwellings or dwelling property lines.<sup>C</sup>
- 7. Reclaimed water shall be applied at a rate and volume not to exceed vegetative demand and soil moisture holding conditions. Special precautions must be taken to prevent clogging of spray nozzles, over-watering and ponding, and to minimize runoff. Pipelines shall be maintained to prevent leaks.
- 8. The reclamation reservoir and other areas with public access shall be posted (in English and Spanish) to warn the public that reclaimed wastewater is being stored or used.<sup>C</sup>
- 9. Personnel involved in producing, transporting, or using reclaimed water shall be informed of possible health hazards that may result from contact and use of reclaimed water.<sup>C</sup>
- 10. Valves in the reclaimed water irrigation system shall be designed and constructed so unauthorized persons cannot open them.<sup>C</sup>
- 11. Reclaimed water valves, outlets, etc. shall be marked to differentiate reclaimed water facilities from potable water facilities. Proper backflow and cross-connection protection for

domestic water services and irrigation wells shall be provided.<sup>C</sup>

- 12. Reclaimed water systems shall be properly labeled and regularly inspected to assure proper operation, absence of leaks, and absence of illegal connections.<sup>C</sup>

**SPECIFICATIONS**

**Effluent Limitations**

- 1. Daily flow averaged over each month shall not exceed 104,000 gallons per day.
- 2. Effluent discharged to the leachfield shall not have a pH less than 6.5 or greater than 8.3.<sup>BP</sup>
- 3. Effluent discharged to the leachfield disposal area shall not exceed the following limits:

Parameter	Units	Maximum
Total Dissolved Solids	mg/l	600
Sodium	"	125
Chloride	"	125
Suspended Solids	"	120
Settleable Solids	ml/l	0.7

- 4. Total Nitrogen in wastewater shall be reduced by at least 50 percent prior to subsurface disposal.<sup>BP</sup> Compliance will be determined from samples taken at points before and after extended treatment.

**Ground Water Limitations**

- 5. The discharge shall not cause a statistically significant increase of mineral constituent (total dissolved solids, sodium, chloride, and nitrate) concentrations in the ground water.
- 6. The discharge shall not cause ground water to exceed concentrations of chemical constituents limits specified in Title 22, Chapter 15, Article 4, Section 64435, of the California Code of Regulations as listed below.<sup>BP</sup>

Constituents	Maximum Contaminant Level (mg/l)
Nitrate (as N)	10

7. The discharge shall not cause concentrations of radionuclides in ground water to exceed limits specified in Title 22, Chapter 15, Articles 5, Section 64443 of the California Code of Regulations.<sup>BP</sup>
8. The discharge shall not cause concentrations of organic chemicals in ground water to exceed limits specified in Title 22, Chapter 15, Articles 5.5, Section 64444.5 of the California Code of Regulations.<sup>BP</sup>

#### System Operation Specifications

9. High water alarms, readily audible or visible to maintenance personnel, shall be installed at the facility.
10. Standby power or portable pumps shall be available for use when wastewater-pumping facilities fail.

#### Solids/Solid Waste Control

11. Solids cleaned from treatment unit shall be disposed of at a septage receiving facility approved by the Regional Board Executive Officer.

#### Stormwater Control

12. Extraneous surface drainage shall be diverted away from the treatment system and leachfield disposal area.

#### PROVISIONS

1. Order No. 96-03, "Waste Discharge Requirements for Santa Cruz County Service Area #7, Boulder Creek Golf and Country Club, Santa Cruz County", adopted by the Regional Board on May 31, 1996, is hereby rescinded.
2. The Discharger shall submit an annual Salts Management Program Report. The report shall detail the steps taken to reduce salts in the effluent. The report shall be submitted with the 1<sup>st</sup> quarter monitoring report for each year.
3. Discharger shall comply with "Monitoring and Reporting Program No. 01-034", and

any amendments thereto, as specified by the Regional Board Executive Officer.

4. The Discharger shall comply with all items of the attached "Standard Provisions and Reporting Requirements for Waste Discharge Requirements" dated January 1984; except Item No. A.8.
5. Pursuant to Title 23, Division 3, Chapter 9 of the California Code of Regulations, the Discharger must submit a written report to the Regional Board Executive Officer no later than January 1, 2010, addressing:
  - a. Whether there will be changes in the continuity, character, location, or volume of the discharge; and
  - b. Whether, in their opinion, there is any portion of the Order that is incorrect, obsolete, or otherwise in need of revision.

#### ATTACHMENTS

1. Attachment A, Site and Vicinity Map
2. Attachment B, Site and Vicinity Map
3. Monitoring and Reporting Program No. 01-034
4. Standard Provisions and Reporting Requirements for Waste Discharge Requirements

I, ROGER W. BRIGGS, Executive Officer, do hereby certify the foregoing is a full, true, and correct copy of an Order adopted by the California Regional Water Quality Control Board, Central Coast Region, on May 18, 2001.

  
\_\_\_\_\_  
Executive Officer

S:\WB\Northern Watershed\TLS\Finalized\WDR\Santa Cruz CSA #7 - Boulder Creek Country Club\01-034 WDR.doc  
Task: 121-01  
File: Discharger file; Santa Cruz CSA #7/ Boulder Creek Golf and Country Club Wastewater Treatment Facility

CALIFORNIA REGIONAL WATER QUALITY CONTROL BOARD  
CENTRAL COAST REGION

MONITORING AND REPORTING PROGRAM NO. 01-034  
FOR  
SANTA CRUZ COUNTY SERVICE AREA (CSA) #7  
BOULDER CREEK GOLF AND COUNTRY CLUB  
SANTA CRUZ COUNTY

**TREATMENT PLANT MONITORING**

The sludge blanket within the clarifier shall be measured according to the following schedule:

Measurement	Units	Measurement Type	Frequency
Distance of sludge blanket from top of overflow weir	Inches	Staff gauge	Monthly

**INFLUENT MONITORING**

Representative influent samples shall be collected before treatment and analyzed for the following:

Parameter	Units	Type of Sample	Minimum Measuring Frequency
BOD, 5-day	mg/l	Grab	Monthly
pH	pH Units	"	"
Organic Nitrogen (N)	mg/l	"	* Twice per month
Nitrate (N)	"	"	"
Nitrite (N)	"	"	"
Ammonia (N)	"	"	"
Total dissolved solids	"	"	Quarterly
Total suspended solids	"	"	"

(N) - All nitrogen data shall be reported as nitrogen.

\*Staff requires monitoring twice per month for the Nitrogen series (Organic Nitrogen, Nitrate, Nitrite, and Ammonia) for a minimum of 15 months. The samples shall be collected at least 10 days apart. After 15 months, Discharger shall submit a report analyzing the nitrogen removal efficiency of the wastewater treatment plant. Regional Board staff will evaluate the report to determine the need and frequency for continued nitrogen monitoring.

**EFFLUENT MONITORING**

Representative effluent samples shall be collected prior to disposal and analyzed for the following:

Parameter	Units	Type of Sample	Minimum Measuring Frequency
Total Flow	Gallons per day (gpd)	Metered	Monthly
Reclaimed Water Flow	"	"	"
Flow to Leachfield	"	"	"
Turbidity	NTU	Continuous	Daily**
Chlorine Residual	mg/l	Continuous	Daily**
Total Coliform Organisms	MPN/100 ml	Grab	Daily/Weekly**
Fecal Coliform Organisms	MPN/100 ml	Grab	Daily/Weekly **
BOD, 5-day	mg/l	Grab	Monthly
pH	pH Units	"	"
Organic Nitrogen (N)	mg/l	"	Twice per month*
Nitrate (N)	"	"	"
Nitrite (N)	"	"	"
Ammonia (N)	"	"	"
Total suspended solids	"	"	Quarterly
Total dissolved solids	"	"	"
Total Settleable solids	"	"	"
Sodium	"	"	"
Chloride	"	"	"

(N) - All nitrogen data shall be reported as nitrogen.

\*Staff requires monitoring twice per month for the Nitrogen series (Organic Nitrogen, Nitrate, Nitrite, and Ammonia) for a minimum of 15 months. The samples shall be collected at least 10 days apart. After 15 months, Discharger shall submit a report analyzing the nitrogen removal efficiency of the wastewater treatment plant. Regional Board staff will evaluate the report to determine the need and frequency for continued nitrogen monitoring.

\*\*Compliance with coliform limits shall be based on the correlation between coliform, turbidity, and chlorine residual. Once a correlation is established, reviewed, and approved, only weekly coliform sampling will be required. However, if the turbidity limit is not achieved, reclamation delivery shall



# ATTACHMENT B

Santa Cruz CSA #7, Boulder Creek Golf and Country Club

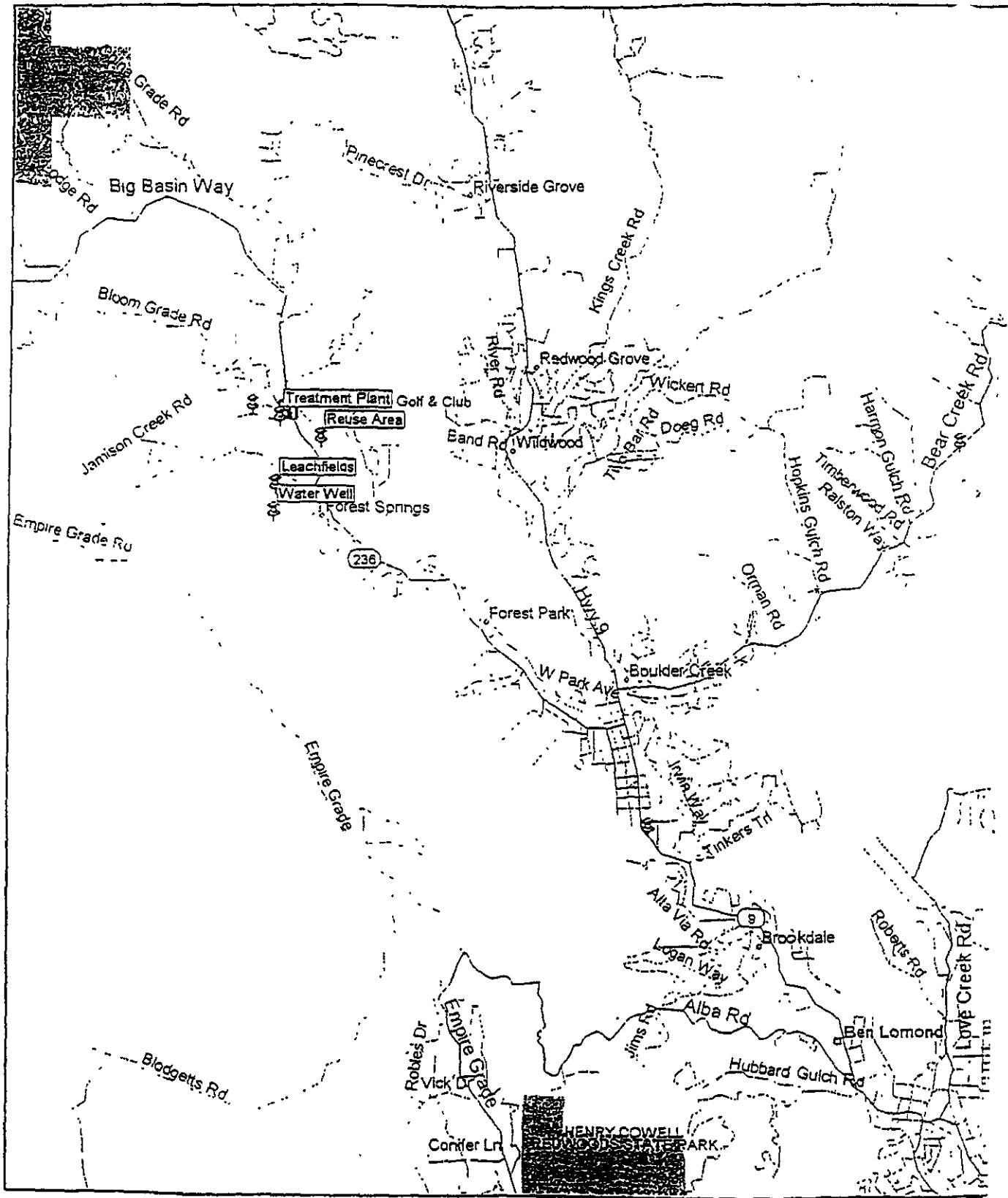

Streets98

ATTACHMENT "A"  
Santa Cruz County Service Area No. 7  
Boulder Creek Golf and Country Club

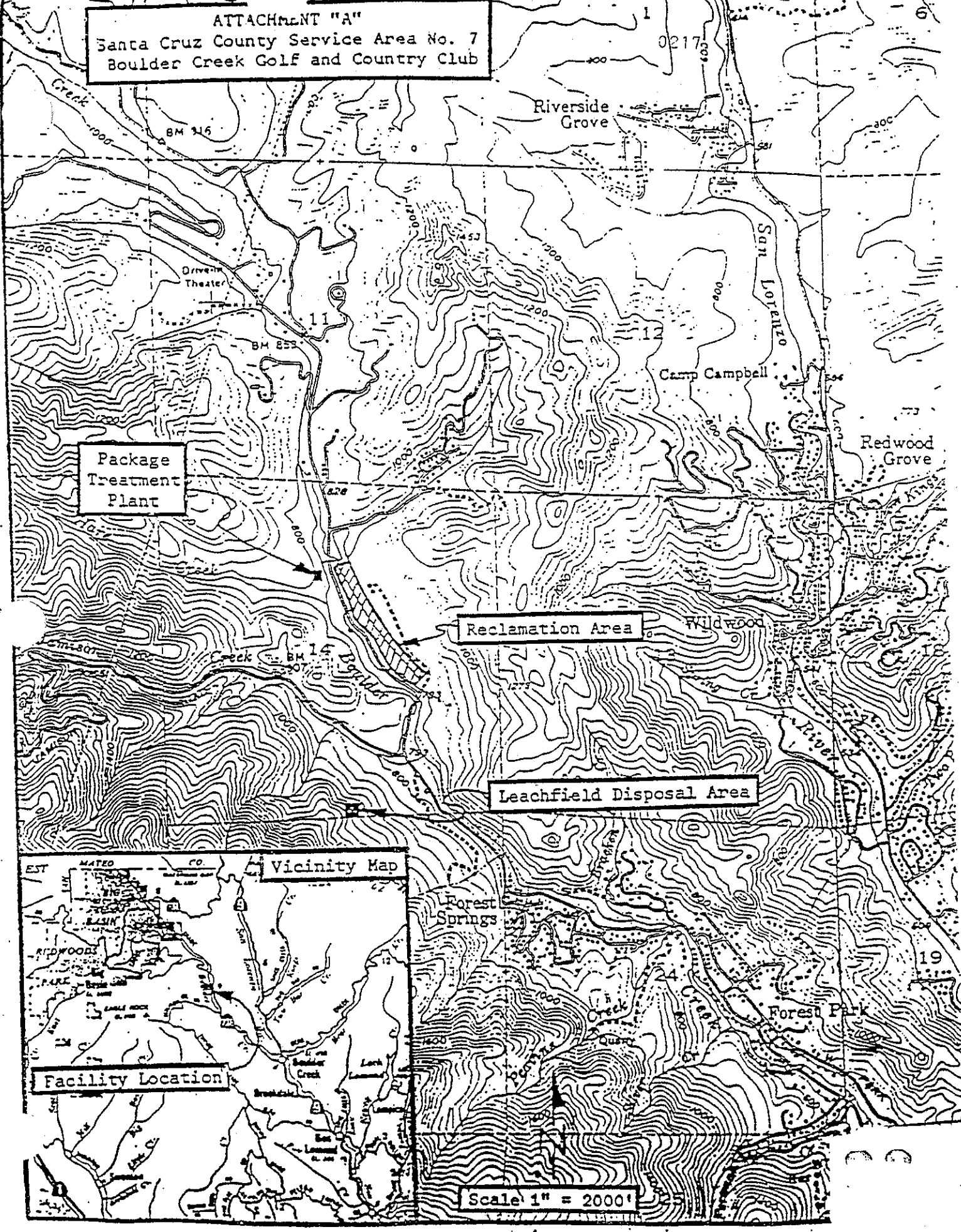

Package  
Treatment  
Plant

Reclamation Area

Leachfield Disposal Area

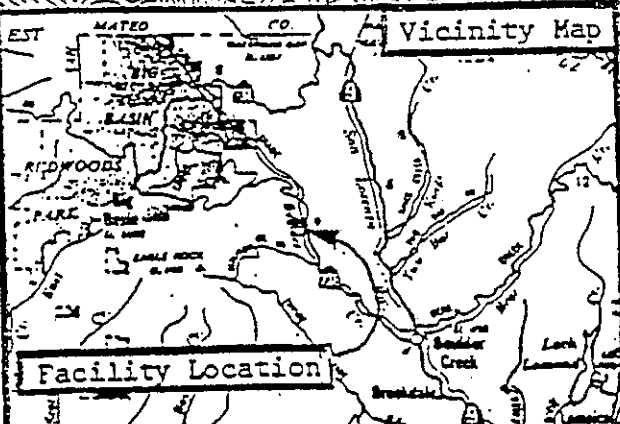

Facility Location

Scale 1" = 2000'



# CALIFORNIA ENVIRONMENTAL PROTECTION AGENCY CUSTOMER SERVICE SURVEY

One of Cal/EPA's objectives is to provide superior levels of customer service. Your feedback telling us what is going well and what needs improvement is essential to our success in our efforts to better serve you. Please take a moment to respond to the following questions.

*Winston H. Hickox, Secretary for Environmental Protection*

**SERVICE PROVIDER:** Regional Water Quality Control Board (San Luis Obispo)

What was the nature of your contact with us? (Please check only one box)

- |  |  |   |
|--|--|---|
| <input type="checkbox"/> General Information             | <input type="checkbox"/> Problem Resolution      | <input type="checkbox"/> Technical Assistance |
| <input type="checkbox"/> Permitting/Licensing Assistance | <input type="checkbox"/> Registration Assistance | <input type="checkbox"/> Other: _____         |

STATEMENTS	Check (✓) As Appropriate			
	Strongly Agree	Agree	Disagree	Strongly Disagree
Staff was courteous and helpful.				
Staff provided complete, accurate information to you.				
A timely response was provided.				
My overall experience was positive.				
<i>Please complete the section below if your contact with us involved permitting/licensing/registration assistance:</i>				
The regulations were understandable.				
The application instructions were understandable.				
The permit/license/registration terms and conditions were understandable.				

◇ Please indicate any staff person you would like to commend: \_\_\_\_\_ Name(s)

◇ Comments:

◇ If you feel we fell short in meeting your service expectations, please describe the situation, including name of the staff person involved and the date the incident occurred.

◇ As a result of your experience with us, what service-related improvements can you recommend?

☐ Please fold this survey in thirds, staple/tape, and mail. Postage will be paid by Cal/EPA.

MONTEREY BAY UNIFIED AIR POLLUTION CONTROL DISTRICT

# PERMIT TO OPERATE

7998A

OPERATION UNDER THIS PERMIT MUST BE CONDUCTED IN COMPLIANCE WITH ALL DATA AND SPECIFICATIONS INCLUDED WITH THE APPLICATION UNDER WHICH THIS PERMIT IS ISSUED. THE EQUIPMENT MUST BE PROPERLY MAINTAINED AND KEPT IN GOOD CONDITION AT ALL TIMES. THIS PERMIT TO OPERATE MUST BE POSTED OR ACCESSIBLE.

LEGAL OWNER  
OR OPERATOR: COUNTY OF SANTA CRUZ  
PUBLIC WORKS/SANITATION DEPARTMENT

EQUIPMENT  
LOCATED AT: Various Locations Within Santa Cruz County

EQUIPMENT  
DESCRIPTION  
AND  
CONDITIONS: THIS PERMIT TO OPERATE IS ISSUED AND IS VALID FOR THIS  
EQUIPMENT ONLY WHILE IT IS IN THE CONFIGURATION SET FORTH  
IN THE FOLLOWING DESCRIPTION:

PORTABLE EMERGENCY INTERNAL COMBUSTION ENGINE-GENERATOR (200 KW S/N  
94-4260-1):

DMT Corporation Model 200JD3 Power System, S/N 94-4260-1. John Deere Model 6076A Diesel Engine, 225-Hp @ 1800 RPM, With Turbocharger And Aftercooler; And Generator, 200 KW Output.

THE EQUIPMENT FOR WHICH THIS PERMIT TO OPERATE IS ISSUED MAY BE OPERATED ONLY WHEN IN COMPLIANCE WITH THE FOLLOWING CONDITIONS:

Conditions:

1. Annual fuel oil #2 usage and operating hours, which include total run and test/exercise time periods, shall be reported to the District, upon request, at the time of permit renewal.
2. The equipment shall be operated less than 60 hours per year for test and exercise purposes.
3. Except for test and exercise purposes, this equipment shall only be operated when the local utility powerline service fails.
4. Total engine fuel usage and operating hours, which include total run and test/exercise time periods, shall be recorded in a log maintained with the equipment. This log shall be made available to District staff upon request.

\*\* Page 1 of 2 \*\*

THIS PERMIT BECOMES VOID UPON ANY CHANGE OF OWNERSHIP OR ADDRESS, OR ANY ALTERATION.

PERMIT DOES NOT AUTHORIZE THE EMISSIONS OF AIR CONTAMINANTS IN EXCESS OF THOSE ALLOWED BY ARTICLE 1, CHAPTER 3, PART 4, DIVISION 26 OF THE HEALTH & SAFETY CODE OF THE STATE OF CALIFORNIA OR THE RULES AND REGULATIONS OF THE AIR POLLUTION CONTROL DISTRICT. THIS PERMIT CANNOT BE CONSIDERED AS PERMISSION TO VIOLATE EXISTING LAWS, ORDINANCES, REGULATIONS OR STATUTES OF OTHER GOVERNMENTAL AGENCIES.

APCD 3

  
AIR POLLUTION CONTROL OFFICER  
DATE: OCT 20 1997

County of Santa Cruz - Public Works/Sanitation Department  
Permit to Operate 7998A  
Page two:

- 5. The sulfur content of any fuel oil consumed shall not exceed 0.5% by weight.
- 6. No emissions shall constitute a public nuisance.
- 7. No air contaminant shall be discharged into the atmosphere for a period or periods aggregating more than three (3) minutes in any one (1) hour which is as dark or darker than Ringelmann 1 or equivalent 20 percent opacity.
- 8. Any representative of the Monterey Bay Unified Air Pollution Control District authorized by the Air Pollution Control Officer shall be permitted, pursuant to the authority contained in Section 41510 of the California Health and Safety Code:
  - a) to enter upon the premises where the source is located or in which any records are required to be kept under the terms and conditions of this Permit to Operate;
  - b) to have access to and copy any records required to be kept under the terms and conditions of this Permit to Operate;
  - c) to inspect any equipment, operation, or process described or required in this Permit to Operate; and,
  - d) to sample emissions from the source.

NOTE: This permit replaces Permit to Operate 7998 issued to the County of Santa Cruz on July 7, 1995. The annual permit renewal date is August 15.

\*\*\*\*

DETAILS - PRINT HERE AND DISPLAY CONSPICUOUSLY ON THE PREMISES

**SANTA CRUZ COUNTY ENVIRONMENTAL HEALTH SERVICE**  
701 OCEAN STREET, ROOM 312  
SANTA CRUZ, CA 95060

831-454-2022

REGULATED FACILITY: BOULDER CREEK CSA #17  
LAKE DR  
BOULDER CREEK, CA 95066

OWNER NAME: COUNTY OF SANTA CRUZ

PR0003085 2122  
PR0004611 2119

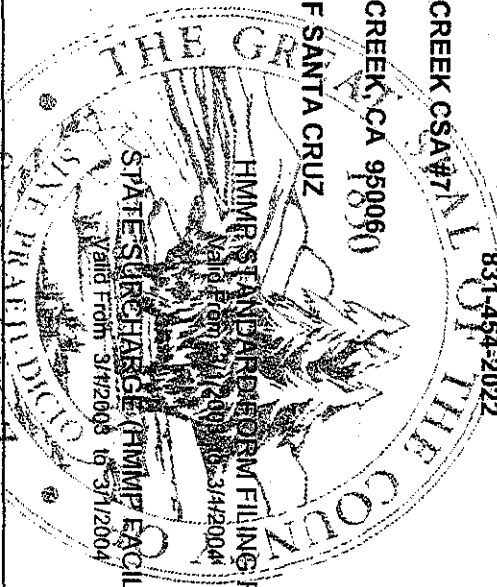

Facility ID: FA0002357  
Account ID: AR0002467  
Issued: 2/27/2003  
Permit Number

93000930  
93000930

Permits to operate and Annual Fee Payments are NOT TRANSFERABLE. Those referenced above are valid ONLY for this owner: COUNTY OF SANTA CRUZ. Permits become VOID on change of ownership. New owners must apply and pay for a new Permit(s) PRIOR to beginning operation or penalties will be assessed.

**SEE REVERSE SIDE OF PERMIT FOR CONDITIONS OF ISSUANCE IF APPLICABLE**  
**THIS FORM MUST BE DISPLAYED CONSPICUOUSLY ON THE PREMISES**